

Project By  天安中國 TIAN AN CHINA INVESTMENTS COMPANY LIMITED

千树
天安 1000 TREES
SHANGHAI

FUN FACTS



The unique pattern of the 1000 Trees Logo was inspired by a Voronoi diagram with key points added to give an overview of the area. The collection of 10 differently-shaped pieces represent the key elements and nature of 1000 Trees—a place where many kinds of creative disciplines gather to create a new definition of living.

Enjoy the Difference

A Crafted Experience

Enjoy the Difference

Shop, work and play in this unique eco chic integrated retail and entertainment mall, located in Shanghai.

Weaving together Greenery, Heritage, Art and Architecture, 1000 Trees combines the best shopping, entertainment and commercial business experience in this neighborhood meeting hub.

Introducing
the Difference



AERIAL VIEW
©Mir

Revitalizing the Neighborhood

1000 Trees was created to breathe new life into the district as a one-stop retail entertainment destination and activity hub for residents and visitors in Shanghai. A development of such scale and beauty acts as a driving transformative force for renewal in the city center as well as a lifestyle focus for the people who live and work in the neighborhood.



Making
the Difference

Entering
the Difference



The Edge Concept

Historically, Shanghai has always been one of China's most cutting edge cities, with other cities taking its lead, whether it's in the field of arts, lifestyle, fashion, entertainment or business.

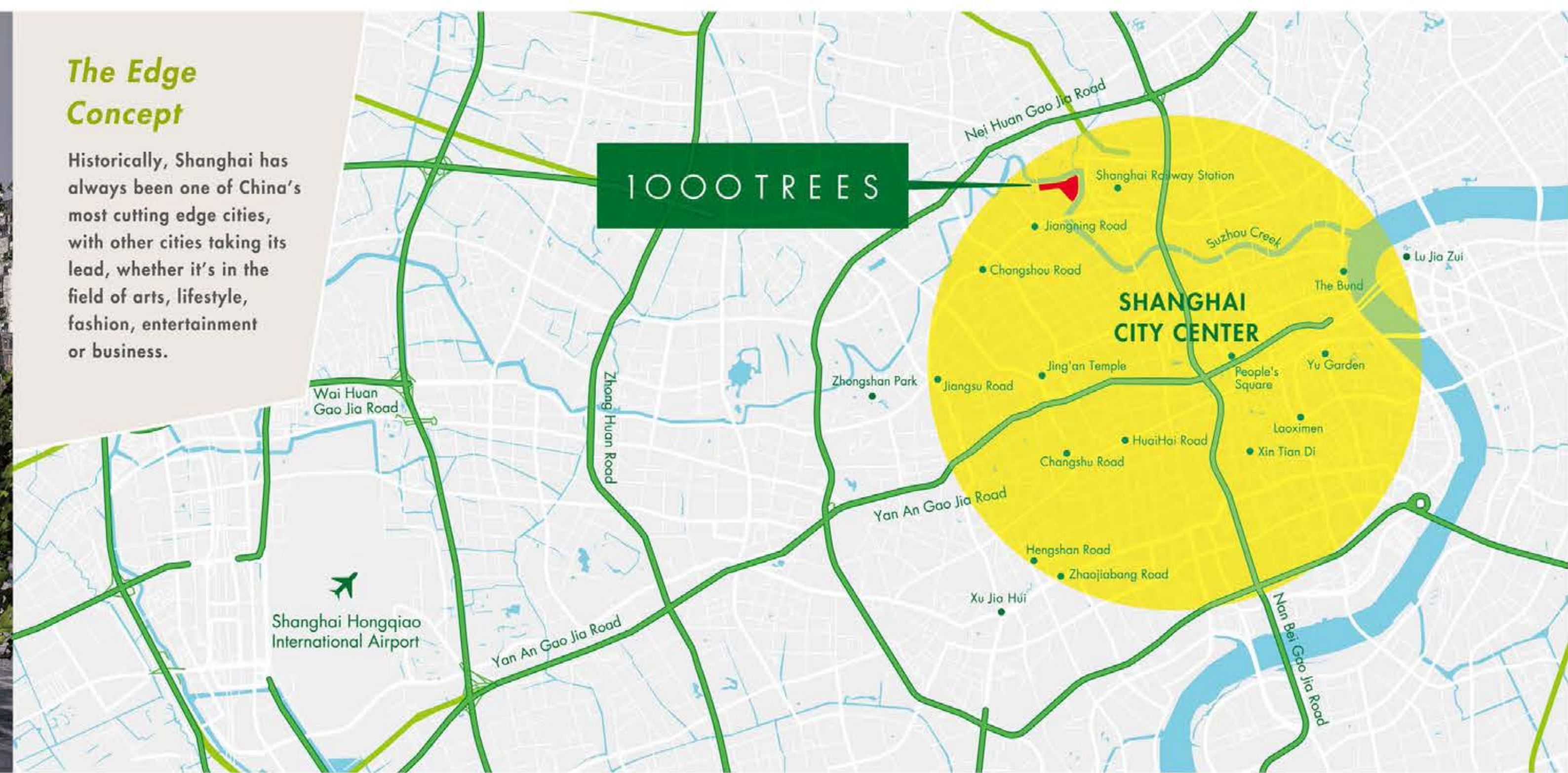

Living Life on the Edge

With 1000 Trees, it now joins the ranks of major cities —London, New York, and Portland— that are renowned for their cutting edge counter-culture lifestyle and for leading the rest of the world in creativity and trends. Being on the Edge of Change is not just a metaphor —it's a lifestyle choice that differentiates the normal and the new.



LONDON



NEW YORK



PORTLAND



SHANGHAI

The creation of one of China's first eco-green retail & entertainment lifestyle malls marks another achievement enabling Shanghai to retain its well-deserved reputation for being on the forefront of any new development.



The Design Philosophy

Heatherwick Studio
 Thomas Heatherwick, Founder and Design Director

Thomas Heatherwick founded Heatherwick Studio in 1994 to bring the practices of design, architecture and urban planning together in a single workspace. Following the success of the UK Pavilion for the Shanghai World Expo in 2010, the studio's best known work includes the Learning Hub at Singapore's Nanyang Technological University and the new Google campus in Silicon Valley, California.

Greenery, Arts, Heritage and Architecture flow together in an organic architectural art-piece that is rarely seen in today's cities, melding gracefully into the 900m long scenic river side of Suzhou Creek while showcasing the best of Shanghai's bustling city life.

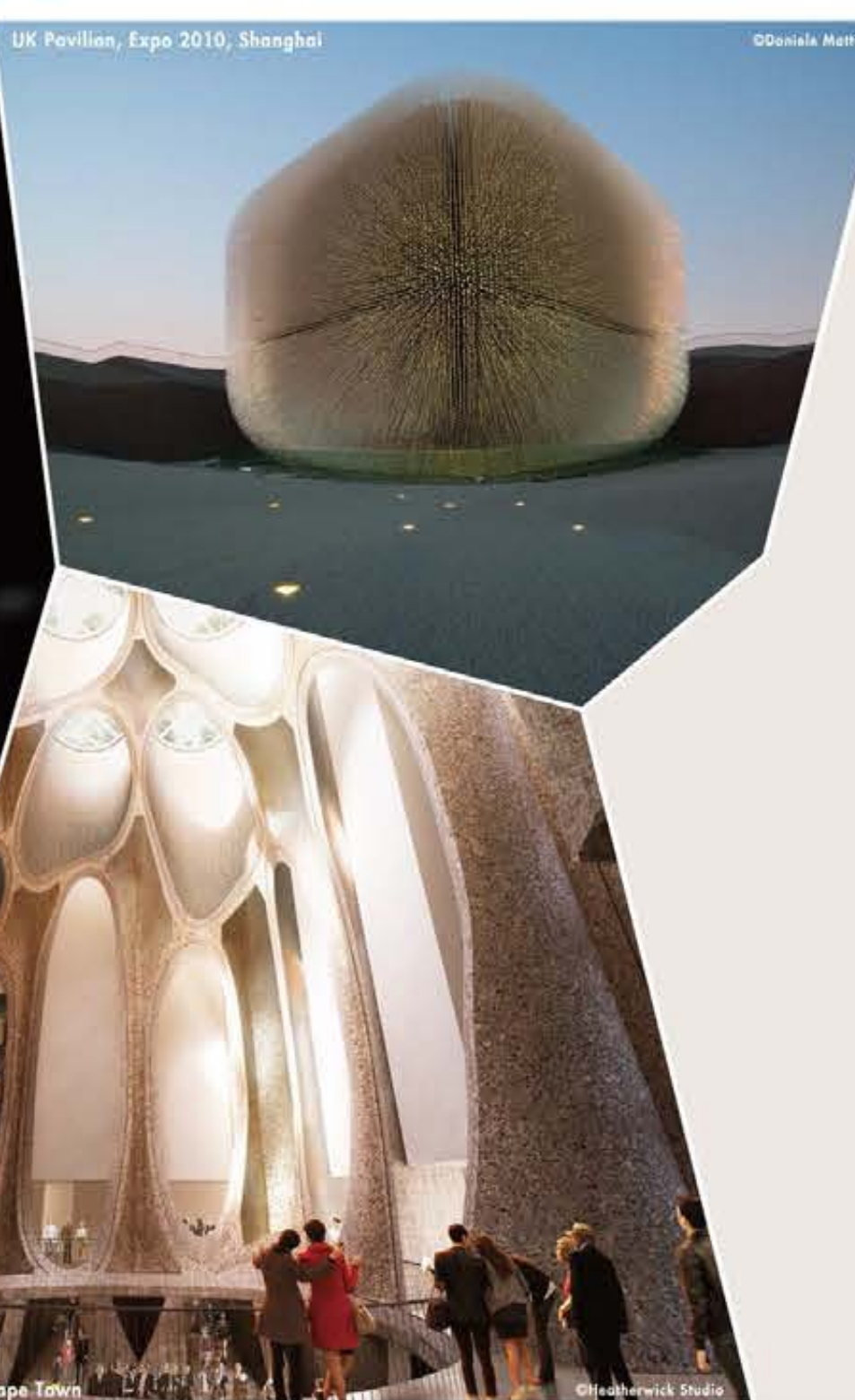

This huge project was extraordinary to be asked to work on because of the way it sits in Shanghai, right next to the Suzhou Creek, a park and M50, the city's main art district. We took our clues from the scale of the old buildings next door and became interested in how to break down the visual feeling of our singular huge development into an accumulation of smaller elements. Our hope is that 1000 Trees will be a transformative piece of topography and when you zoom in, it will reveal a multitude of human scale places, framing the lives of the people that live and work there.

Thomas Heatherwick
 Founder and Design Director of Heatherwick Studio



The Greenery

1000 Trees' overall design flows perfectly with the scenic Suzhou Creek, rising up like tree-covered mountains beside the river in poetic homage to Huangshan Mountain from which it drew its creative inspiration. The landscaped trees harmoniously blend natural aesthetics, visual art and heritage to create a commercial environment capable of offering an unforgettable shopper experience while maintaining its natural green origins. The landscape helps people enjoy seasonal experiences while providing a green breathing space with serene vistas of trees and foliage.

*Experience
the Difference*



The Heritage

Elements of the city's heritage such as the historical Fufeng Flour Mill and the old Packaging Warehouse are carefully preserved, giving new life and revitalization in homage to the rich cultural past of Shanghai. Visitors can be further engaged by activities and events inspired by the rich cultural past of these buildings, such as Arts + Craft School, Restaurants, Museums, and Galleries.

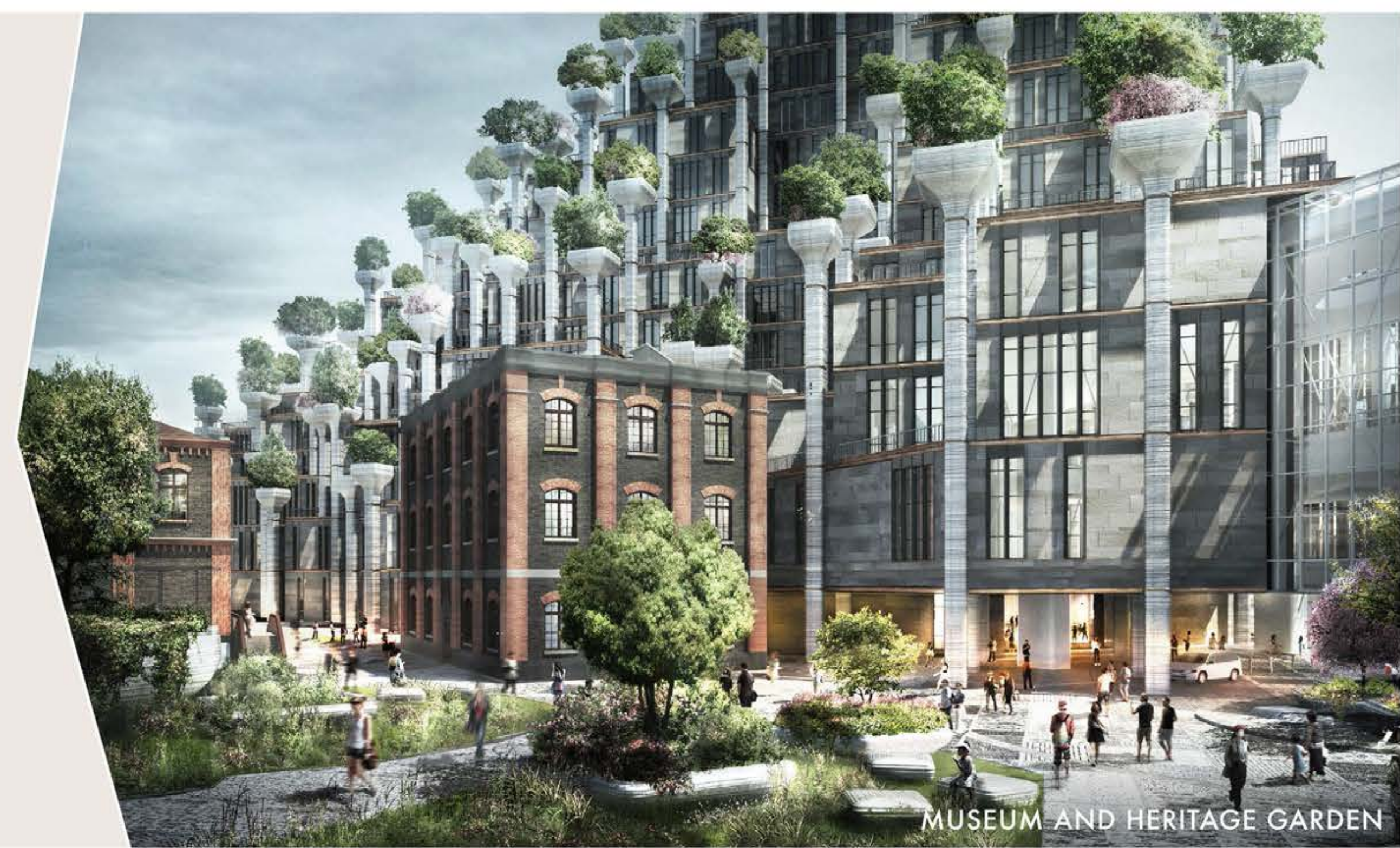

The Art

This showcase to human ingenuity captures snapshots of Shanghai's rich past and contrasts it with the modernity of the M50 arts district, already renowned for its cutting edge modern art works. A series of avant-garde street art exhibits by 12 of the leading international and local street art artists such as VHILS, Daleast and Mode 2 will be permanently on display on building facades, providing a masterful blend of old and new plus providing a unique retail, arts & entertainment lifestyle flavor to the area. There will also be an arts theater restaurant with an attached bookstore to support local music and performing arts.

MOGANSHAN ROAD VIEW

*Visualizing
the Difference*

Blending Retail, Nature and Lifestyle

The architectural flow brings out the best aspects of nature, functionality and retail. Green-inspired columns and nature-themed surroundings give shoppers the unique experience of shopping, dining and living within a modern eco-sphere.



WEST MOUNTAIN RETAIL ATRIUM



WEST MOUNTAIN RETAIL ENTRANCE ATRIUM

*Feel
the Difference*



*Exploring
the Difference*



SUGAR RUSH

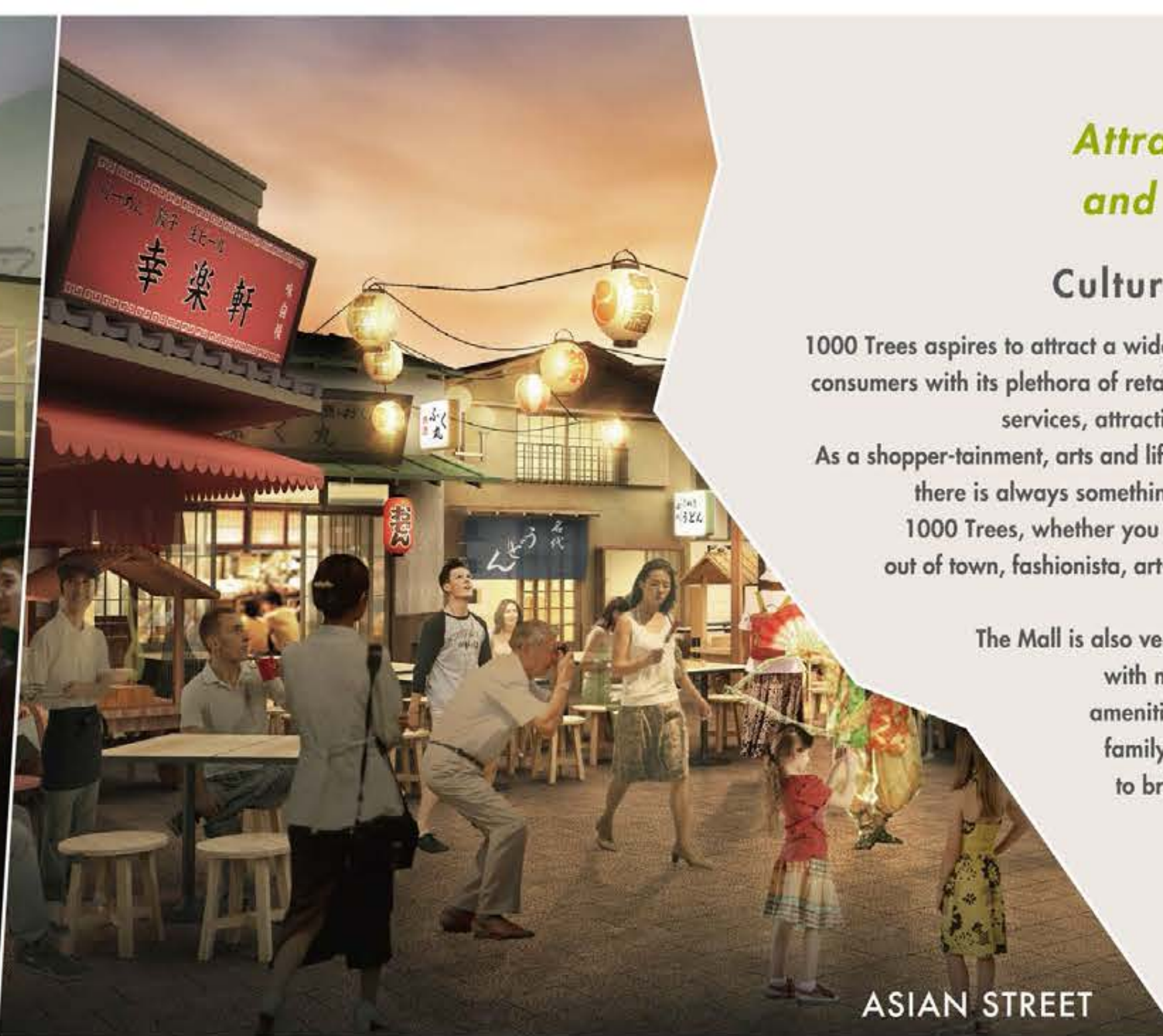

ASIAN STREET

**Attract, Excite
and Entertain**

Cultural Village

1000 Trees aspires to attract a wide range of quality consumers with its plethora of retail options, dining, services, attractions and features.

As a shopper-tainment, arts and lifestyle destination, there is always something for everyone at 1000 Trees, whether you are a visitor from out of town, fashionista, art-lover or gourmet.

The Mall is also very family-oriented with many services and amenities targeted to the family, the perfect place to bring the family out on a weekend.

Generation Lifestyle

Dining & Activity

A stunning range of the best dining establishments in town—both local and international—will provide an irresistible draw. These include terrace cafes, smaller eateries, casual dining restaurants and fine dining as well as a food street concept that can showcase different genres of gourmet enjoyment every few months.

Arts and Entertainment

Going beyond the traditional retail mall style, 1000 Trees also inspires the artistic community as an arts and creative platform with free open arts space, outdoor movies and museums for artists to showcase their best works and performances.

FOOD COURT



STREET ART LIFT LOBBY



STREET ART FACADE

OUTDOOR MOVIES



*Indulging
the Difference*





Showcasing Retail, Dining and Entertainment in Town

Covering over 100,000 sq meters, 1000 Trees aspires to be a showcase containing the very best of fashion retail, home décor, gourmet dining, organic supermarkets, performance art theatre, heritage center, museums, arts spaces, art galleries, outdoor movie, children's playgrounds and a boutique hotel. Amenities abound, leaving consumers spoiled for choice.

Redefining the Retail Experience

Achieving the right mix of shopping, dining and entertainment brands is the key to success for any commercial retail development. That is why we have crafted a superb shopper experience —that will appeal to key target consumers— comprising the best brands from across the globe. Expect to be amazed with unique fashion lines from famous international brands while numerous art space, galleries and entertainment venues provide a visual feast for the eyes and an unforgettable engaging experience.

Showing the Difference

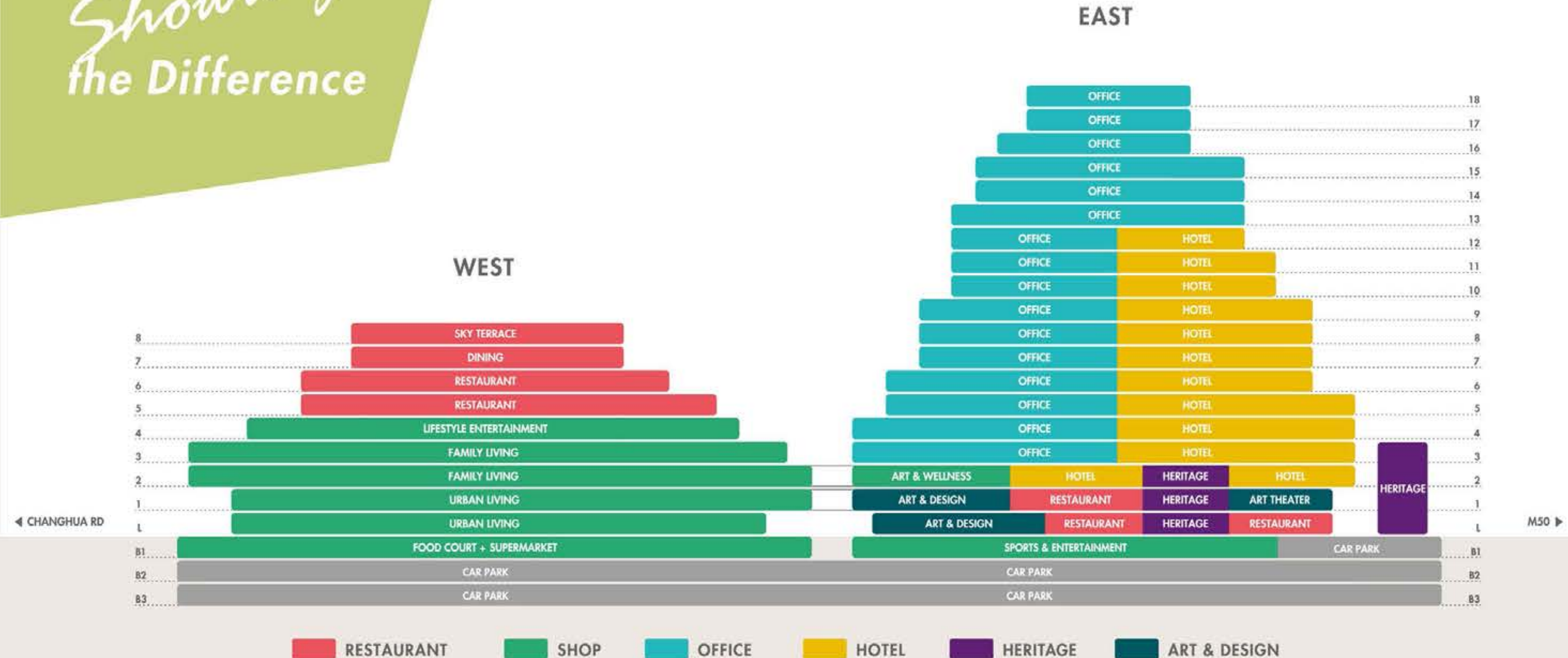



EAST WEST LINK BRIDGE



RETAIL ATRIUM

Creating a Living Flow

1000 Trees signature design style integrates its many different zones into a seamless whole, with a very logical and smooth flow to ensure the most enjoyable experience possible for consumers. The uniquely shaped West Mountain retail atrium connectors bridging the two levels of the main structures and basement linkages were carefully designed to enhance traffic flow between the different zones while maintaining a high visibility for retailers and businesses.



RETAIL SPINE

Linking
the Difference

Comfort, Conduciveness and Convenience

1000 Trees offers commercial concerns a wide range of office space options of many sizes, giving them a conducive, intuitive and comfortable place with cascading garden balconies to conduct their business. Carefully designed with productivity in mind, office spaces feature personalized services to local and international enterprises while lending an air of prestige with avant-garde office designs that epitomize corporate success.

OFFICE LOBBY

Comfort and Luxury in the Heart of the City

Whether you're just visiting Shanghai or staying long term, 1000 Trees boasts a luxurious 280 plus rooms boutique hotel with a 25 meter indoor infinity edge swimming pool and health spa facilities overlooking the Suzhou River and Park, providing a home away from home in bustling Shanghai.

*Living
the Difference*

HOTEL ROOM BALCONY

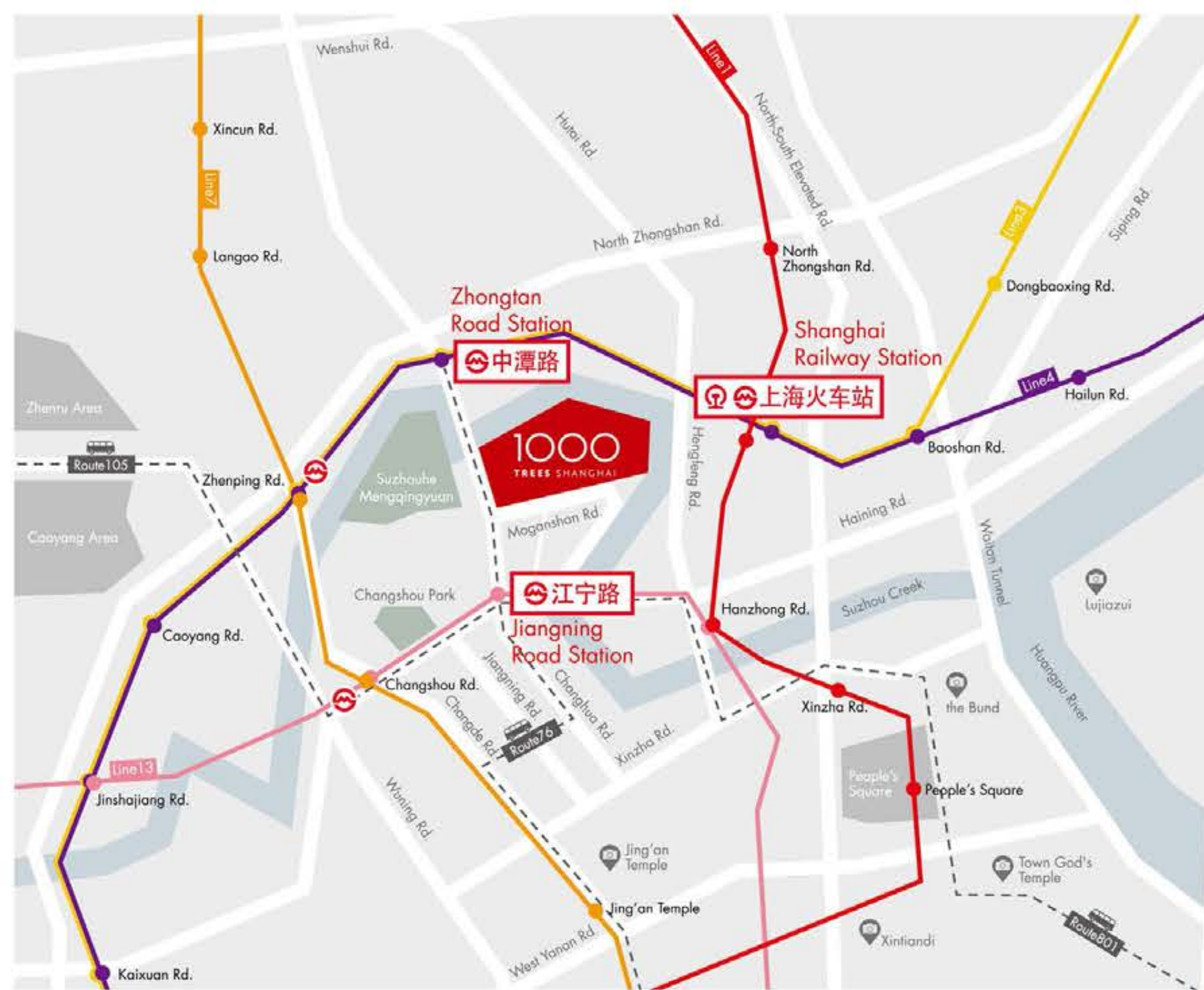

Connectivity

Seamless Integration into Shanghai's Vibrant Cityscape

1000 Trees' prime location and accessibility also play key roles in its successful integration into the city center as both a neighborhood mall and retail lifestyle entertainment destination. Five Metro lines (Lines 1, 3, 4, 7 & 13) in addition to numerous bus routes (76, 105 & 801) provide easy access to the development while its close proximity to People's Square (5km) and commercial hubs such as East Nanjing Road and Huaihai Road ensure that 1000 Trees is only a few minutes' drive from the center of Shanghai as well as the Inner Ring Road.



The location is also close to major tourist attractions in the area such as Jingan Temple and Xintiandi. Water connection to other waterside locations such as the The Bund, Oriental Pearl Tower and the Riverside Promenade in Pudong.

*Integrating
the Difference*



The Oasis

This unique concept strives to return the beauty of Nature to a bustling urban sprawl, retaining and enhancing the look and feel of the area's previous incarnation as a green urban oasis. Residents will gain an urban green lung feature to their neighborhood, unlike anything envisioned in other commercial projects.



1000Trees was conceived not only as an urban neighborhood revitalization project, but a well-scaled "Green Lung" space that engages its surrounding neighborhoods. Since Shanghai was built, its cityscape has been inextricably linked to the Suzhou Creek; but over the years, her greenery had drastically been diminished under the pretext of growth.

1000Trees project was created by Tian An in partnership with world-class designers and professionals.

Drawing inspirations from Architecture, Arts, Natural greenery and Heritage, to reestablish an "Eco-Green Urban-Oasis" that will nourish the future generations with multifaceted, vibrant and enjoyable experience that is unfounded in Shanghai. We hope you will all enjoy it as much as we enjoy building it.

Patrick Lee
Chief Executive Officer

Heatherwick studio

ARUP

MLA
ARCHITECTS PA, LLC

SPEIRS + MAJOR

达源CAPTIVE
CREATIVE + PLANNING + RECONNECT

EFC⁺

LEOX

华建集团
上海建筑设计研究院有限公司
HUAJIAN GROUP
SHANGHAI INSTITUTE OF ARCHITECTURAL DESIGN CO., LTD.

P&T GROUP

Mode

Wutis

上海凯旋门艺术设计有限公司
SHANGHAI KAI XUAN MEN ART DESIGN CO., LTD.

Drill



www.1000trees.com.cn



上海凯旋门企业发展有限公司
Shanghai Kai Xuan Men Real Estate Co., Ltd.
A TIAN AN GROUP COMPANY

LEASING CENTER

Room2308, Tian An Centre, 338 Nanjing Road.(W.), Shanghai 200003 China
+86-21-63273535

The information contained in this promotional material is for illustration purposes only and has no legal value. This is a solicitation which shall not be deemed as either the content of the facility contract or leasing contract or the standard or condition set for property delivery, which will be subject to the terms of contract. Statements, figures, calculations, plans, images, and representations are indicative only. Images may include sketches, artist impressions, photographs and computer generated images. Whilst all reasonable care has been taken in providing this information, the developer and its related companies and their representatives, consultants and agents accept no responsibility for the accuracy of any information contained herein or for any action taken in reliance thereon by any party. The plans, specifications, images and other details herein are only indicative and subject to change and to the approval of the concerned authorities. The developer reserves the right to change any or all contents in this promotional material in the interest of the development without prior notice or obligation.